



KERDI-DRAIN Shower Checklist

Project reference: _____

FOOTPRINT & BASE

Measurement of Shower

Width: _____ Length: _____ Drain placement: Center Other

1 Pre-sloped KERDI Shower Tray or Mortar Bed

Note: Includes pre-cut piece of KERDI. Trays can be modified by cutting or extending with dry-pack mortar.

38" x 38" 48" x 48"
(ST-97) (ST122)

72" x 72" 48" x 72"
(ST183) (ST-122/183)

32" x 60" Center 32" x 60" Off Set
(ST81/152) (ST81/152 BR)

Note: Be sure to order enough KERDI membrane to cover the surface of the mortar bed.

2 Curbs

38" L x 6" H x 4-1/2" W
(KBSC 115 150 970)

Qty: _____

48" L x 6" H x 4-1/2" W
(KBSC 115 150 1220)

Qty: _____

and/or Ramps

48" L x 15-7/8" W x 1-1/2" H
(SR122)

Qty: _____

WALLS

Measurement of Walls

Wall #1: _____ x _____ = _____ Wall #2: _____ x _____ = _____

Wall #3: _____ x _____ = _____ Wall #4: _____ x _____ = _____

Wall #5: _____ x _____ = _____ Total ft² = _____

3 Type of Wall and Waterproofing

3a. Solid backing with KERDI or **3b. Waterproof building panel**

Dry wall

Concrete board

KERDI membrane (39" wide)

3' 3" x 16' 5" (54 ft²)
(KERDI200/5M)

3' 3" x 33' (108 ft²)
(KERDI200/10M)

3' 3" x 65' 7" (215 ft²)
(KERDI200/20M)

3' 3" x 98' 5" (323 ft²)
(KERDI200)

KERDI-BOARD

32" x 48" x 0.5"
(KB121220812)

64" x 48" x 0.5"
(KB1212201625)

96" x 48" x 0.5"
(KB1212202440)

KERDI-BOARD-ZT/-ZS

Washers

Screws

4 KERDI-BAND

(5" wide - used to connect KERDI membrane or KERDI-BOARD with 2" overlap)

Linear feet wall seams: _____ Linear feet pan seams: _____

5" x 16' 5" 5" x 33' 5" x 98' 5"
(KEBA100/125/5M) (KEBA100/125/10M) (KEBA100/125)

5 KERDI-KERECK (waterproof corners)

Note: Drain Kit includes 4 inside and 2 outside corners

Inside corners: _____
(KERECK/FI2 - 2 pack or KERECK/FI10 - 10 pack)

Outside corners: _____
(KERECK/FA2 - 2 pack or KERECK/FA10 - 10 pack)

6 KERDI-SEALS (waterproof seals)

Note: Drain Kit includes 1 pipe seal with 3/4" opening and mixing valve seal

Pipe seal: _____ Mixing valve seal: _____
(KMS185/12 - 1/2" opening or KMS185/20 - 3/4" opening) (KMSMV235/114 - 1 unit or KMSMV10235/114 - 10 units)

OPTIONAL: KERDI-FIX (sealing and bonding compound)

290 ml **290 ml** **100 ml**
KERDIFIX/BW (Bright white) KERDIFIX/G (Grey) KERDIFIX/100G (Grey)

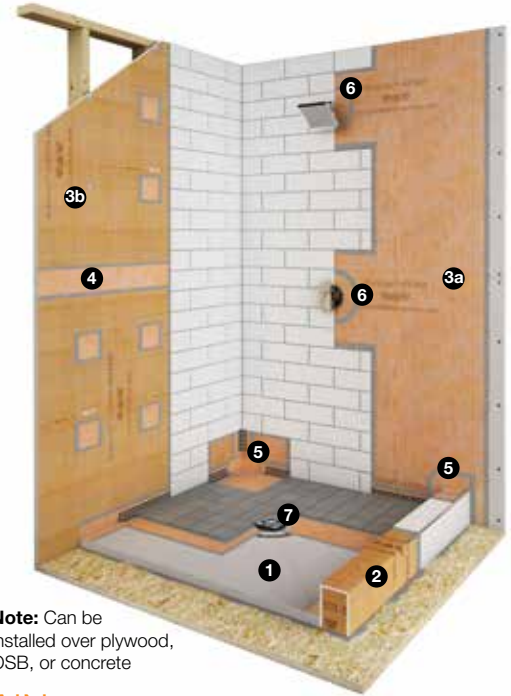

Note: Can be installed over plywood, OSB, or concrete

DRAIN

7 Grate Selection

Stainless Steel



Stainless steel (E)



Chrome (EP)



Oil rubbed bronze (EOB)

Anodized Aluminum



Brushed nickel (ATGB)



Brushed copper (AKGB)



Brushed brass (AMGB)



Tileable (ECS)

ACCESSORIES

KERDI-BOARD Benches

Note: Waterproofing corners are included

Triangle:

22-5/8" L x 16" W x 20" H
(KBSB 410 TA)

34" L x 24" W x 20" H
(KBSB 610 TA)

Rectangle:

38" L x 11.5" W x 20" H 48" L x 16" W x 20" H
(KBSB 290 970 RA) (KBSB 410 1220 RA)

KERDI-BOARD to Make a Custom Bench

96" x 24.5" x 2"

KERECK Bench/Neo-angle Corner Kit

1 right and 1 left bench corner, and two 135° inside corners

KERDI-BOARD Niches

12" W x 6" H 12" W x 12" H
(KB12SN305152A) (KB12SN305305A)

12" W x 20" H 12" W x 28" H
(KB12SN305508A1 - with shelf) (KB12SN305711A1 - with shelf)



NEW! Schluter® Thin-set Mortar





KERDI-LINE Shower Checklist

Project reference: _____

FOOTPRINT & BASE

Measurement of Shower

Width: _____ Length: _____ Drain placement: Center Other

1 Pre-sloped KERDI Shower Tray or Mortar Bed

Wall drain placement

39" x 39" 55" x 55"
(KSL1000S) (KSL1400S)

Center drain placement

39" x 39" 55" x 55"
(KSL1000) (KSL1400)

Note: be sure to order enough KERDI membrane to cover the surface of the mortar bed.

2 Curbs and/or Ramps

38" L x 6" H x 4-1/2" W
(KBSC 115 150 970)

Qty: _____

48" L x 15-7/8" W x 1-1/2" H
(SR122)

Qty: _____

48" L x 6" H x 4-1/2" W
(KBSC 115 150 1220)

Qty: _____

WALLS

Measurement of Walls

Wall #1: _____ x _____ = _____ Wall #2: _____ x _____ = _____

Wall #3: _____ x _____ = _____ Wall #4: _____ x _____ = _____

Wall #5: _____ x _____ = _____ Total ft² = _____

3 Type of Wall and Waterproofing

3a. Solid backing with KERDI or **3b.** Waterproof building panel

Dry wall

Concrete board

KERDI membrane (39" wide)

3' 3" x 16' 5" (54 ft²)
(KERDI200/5M)

3' 3" x 33' (108 ft²)
(KERDI200/10M)

3' 3" x 65' 7" (215 ft²)
(KERDI200/20M)

3' 3" x 98' 5" (323 ft²)
(KERDI200)

KERDI-BOARD

32" x 48" x 0.5"
(KB121220812)

64" x 48" x 0.5"
(KB1212201625)

96" x 48" x 0.5"
(KB1212202440)

KERDI-BOARD-ZT/-ZS

Washers

Screws

4 KERDI-BAND

(5" wide - used to connect KERDI membrane or KERDI-BOARD with 2" overlap)

Linear feet wall seams: _____ Linear feet pan seams: _____

5" x 16' 5" 5" x 33' 5" x 98' 5"
(KEBA100/125/5M) (KEBA100/125/10M) (KEBA100/125)

5 KERDI-KERECK (waterproof corners)

Note: Drain Kit includes 4 inside and 2 outside corners

Inside corners: _____ Outside corners: _____
(KERECK/FI2 - 2 pack or KERECK/FH10 - 10 pack) (KERECK/FA2 - 2 pack or KERECK/FA10 - 10 pack)

6 KERDI-SEALS (waterproof seals)

Note: Drain Kit includes 1 pipe seal with 3/4" opening and mixing valve seal

Pipe seal: _____ Mixing valve seal: _____
(KMS185/12 - 1/2" opening or KMS185/20 - 3/4" opening) (KMSMV235/114 -1 unit or KMSMV10235/114 -10 units)

OPTIONAL: KERDI-FIX (sealing and bonding compound)

290 ml **290 ml** **100 ml**
KERDIFIX/BW (Bright white) KERDIFIX/G (Grey) KERDIFIX/100G (Grey)



Note: Can be installed over plywood, OSB, or concrete

DRAIN

7 Grate Selection

Center outlet Off-set outlet

Length: _____

Note: The stated length of the KERDI-LINE is the size of the grate, the actual opening must be larger to accommodate the flange.

Type of grate:

Closed grate (A)



Stainless steel (EB)



Chrome (EP)

Perforated grate (B)



Stainless steel (EB)



Chrome (EP)

Frameless tileable (D)



If you have selected grates A or B you must choose your frame height:



3/4" - 19 mm frame height
for tile thicknesses of 1/8" - 9/16"



1-1/8" - 30 mm frame height
for tile thicknesses of 1/2" - 1"

ACCESSORIES

All accessories such as benches and niches can be selected on the other side of this page.

IMPORTANT: Please read the Schluter®-Shower System Installation Handbook and Schluter®-Shower System Technical Data Sheet to ensure the materials you have selected are appropriate for your application.

View installation videos at: www.schluter.com